

Since  
**2006**  
TTL Loupe  
&  
LED Light  
(Wireless)



**NK**vision

[www.nkvision.net](http://www.nkvision.net)



CE FDA

# Why NK loupe ?

 German mineral lens

 Premium lens

## Building User Convenience

1. NK's frame design is lighter than flip-up type and other company's TTL loupes by ergonomically designing. and this stable frame is made of pure titanium and is coted with special plating, and cut off the source of allergy.
2. It has a wide field and depth by using mineral lenses.

## Correct posture

NK Loupes help you correct your posture by guiding you to the right posture.  
It provides a large view of the image to reduce eye strain.  
It's easier and more precise to practice.



## Advantage of TTL loupe

1. TTL loupes are attached to glasses, so it has a wide visibility because they are close to the distance.
2. TTL loupes are light because they don't have PD control device.

## Magnification Option (ex. Working Distance : 40cm)

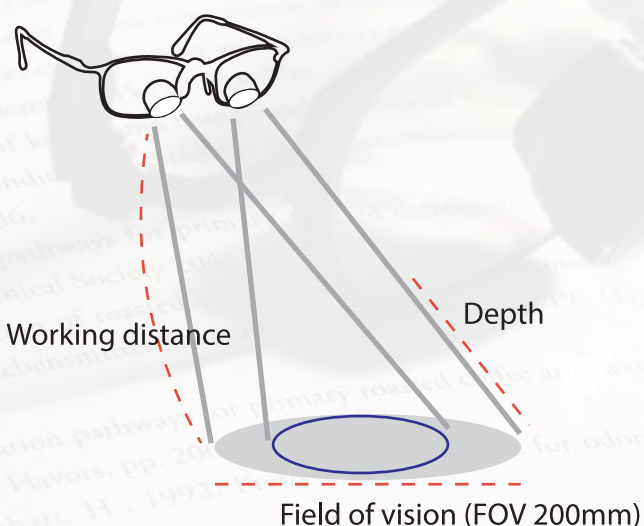

x 2.5



x 3.0



x 3.3



x 3.8



x 5.0



x 6.0







## x 2.5

Style	TTL
Magnification	x2.5
Weight (g)	30
Field of view (mm)	200 @400
Resolution	More than 33 IP/mm <sup>2</sup>
Image flatness	Less than 0.1 Diopter
Depth (mm)	170 @400

## x 3.0

Style	TTL
Magnification	x3.0
Weight (g)	37
Field of view (mm)	130 @400
Resolution	More than 33 IP/mm <sup>2</sup>
Image flatness	Less than 0.1 Diopter
Depth (mm)	130 @400

## x 3.3

Style	TTL
Magnification	x3.3
Weight (g)	60
Field of view (mm)	100 @400
Resolution	More than 35 IP/mm <sup>2</sup>
Image flatness	Less than 0.1 Diopter
Depth (mm)	80 @400

**BLUE**



**WINE**



**SILVER**



**BLACK**



**NK00**

SIZE 144\_50\_144

Style	TTL
Magnification	x2.5 / x3.0 / x3.3 / x3.8 / x5.0 / x6.0
Model name	NK 00
Color	Blue / Wine / Silver / Black



x 3.8

Style	TTL
Magnification	x3.8
Weight (g)	58
Field of view (mm)	80 @400
Resolution	More than 38 IP/mm <sup>2</sup>
Image flatness	Less than 0.02 Diopter
Depth (mm)	60 @400

x 5.0

Style	TTL
Magnification	x5.0
Weight (g)	58
Field of view (mm)	70 @400
Resolution	More than 38 IP/mm <sup>2</sup>
Image flatness	Less than 0.02 Diopter
Depth (mm)	50 @400

x 6.0

Style	TTL
Magnification	x6.0
Weight (g)	60
Field of view (mm)	60 @400
Resolution	More than 39 IP/mm <sup>2</sup>
Image flatness	Less than 0.02 Diopter
Depth (mm)	50 @400

**RED**  
**/BLACK**



**IVORY**  
**/BLACK**



**GREEN**  
**/BROWN**



**ALL**  
**BLACK**



**NK01**

SIZE 142\_48\_144

Style	TTL
Magnification	x2.5 / x3.0 / x3.3 / x3.8 / x5.0 / x6.0
Model name	NK 01
Color	Ivory_Black / Red_Black / Green_Brown / Black



x 2.5

Style	Flip-up
Magnification	x2.5
Weight(g)	95
Field of view (mm)	120 @420
Depth (mm)	220 @420

x 3.0

Style	Flip-up
Magnification	x3.0
Weight(g)	105
Field of view (mm)	110 @420
Depth (mm)	150 @420

Flip-up x2.5 / x3.0

Style	Flip- up
Magnification	x2.5 / x3.0
Model name	NK-F
Color	Black, Blue, Red, Silver

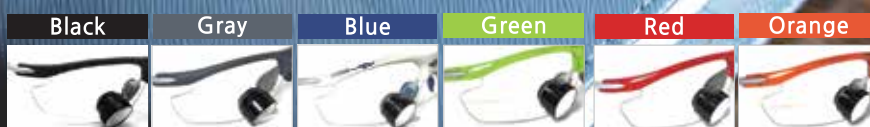

Goggle x2.5 / x3.0

Style	Goggle
Magnification	x2.5 / x3.0
Model name	NK-G
Color	Black, Gray, Blue, Green, Red, Orange



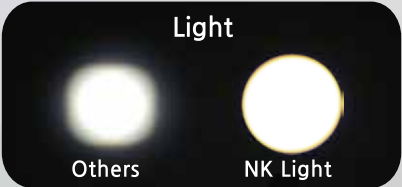

Others

NK Light



## LED Light

Wire & Wireless

Style	LED Light
Brightness	55,000 Lux ~ 140,000 Lux
Model name	NK Multi Light
Light Color	White + Yellow

## UV cut-off filter



ON/OFF and  
Control of brightness



Battery



## Battery

Light battery

Style	Battery	Wireless Battery
Bufferung hour	7~10 hr	60min ~ 100min
Charging times allowed	600 times	300 times
Color	Black	Black

# Detail

This stable frame is made of pure titanium and is coted with special plating.

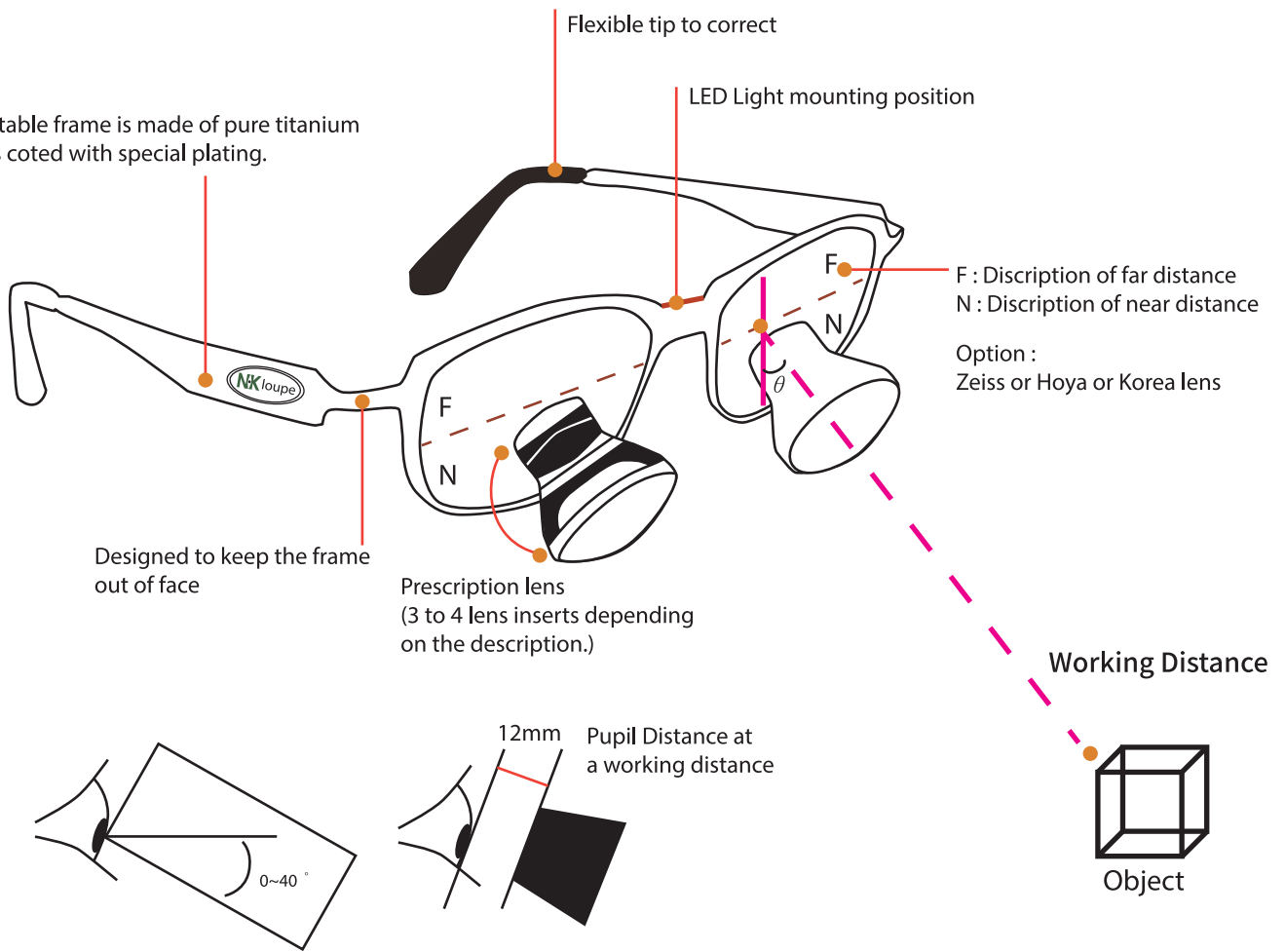

**NK00**

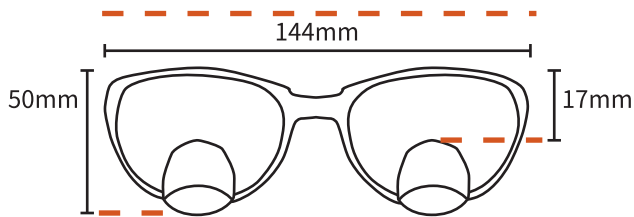

**NK01**

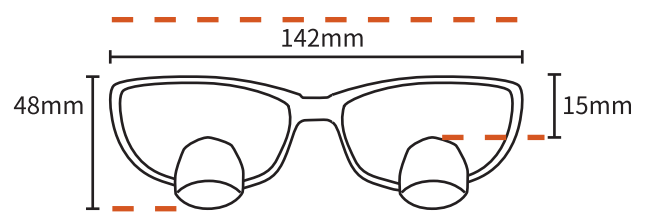

● Customized Deuch mineral lens ●

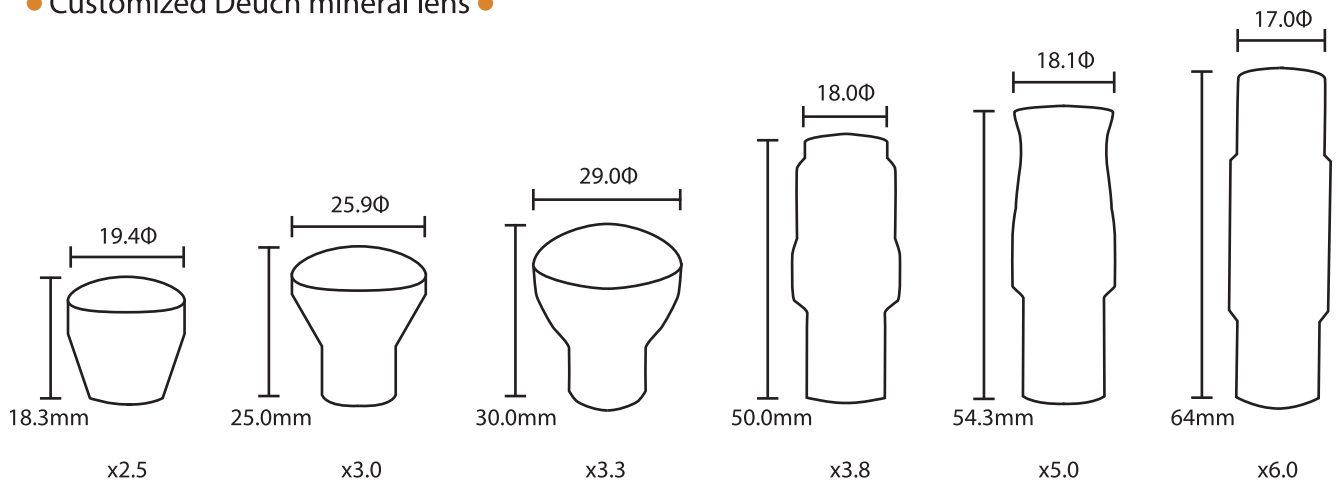



**N·K**vision .inc

Office : 62-3, Dalgubeol-daero 447-gil, Jung-gu, Daegu, Republic of Korea

TEL.+82 - 70-4134-7257  
Email. nkvision1001@gmail.com



[www.nkvision.net](http://www.nkvision.net)